



CR0068

FITTING INSTRUCTIONS FOR CR0068BK/WH COTTON REELS
KAWASAKI NINJA 400 2018-

Page | 1



THIS KIT CONTAINS THE ITEMS PICTURED AND LABELLED BELOW.
DO NOT PROCEED UNTIL YOU ARE SURE ALL PARTS ARE PRESENT.

Please note that the way the kit is packed does not necessarily represent the way of mounting to the bike

THE PARTS SHOWN MAY BE REPRESENTATIVE ONLY (FOR CLARITY OF INSTRUCTIONS ONLY)

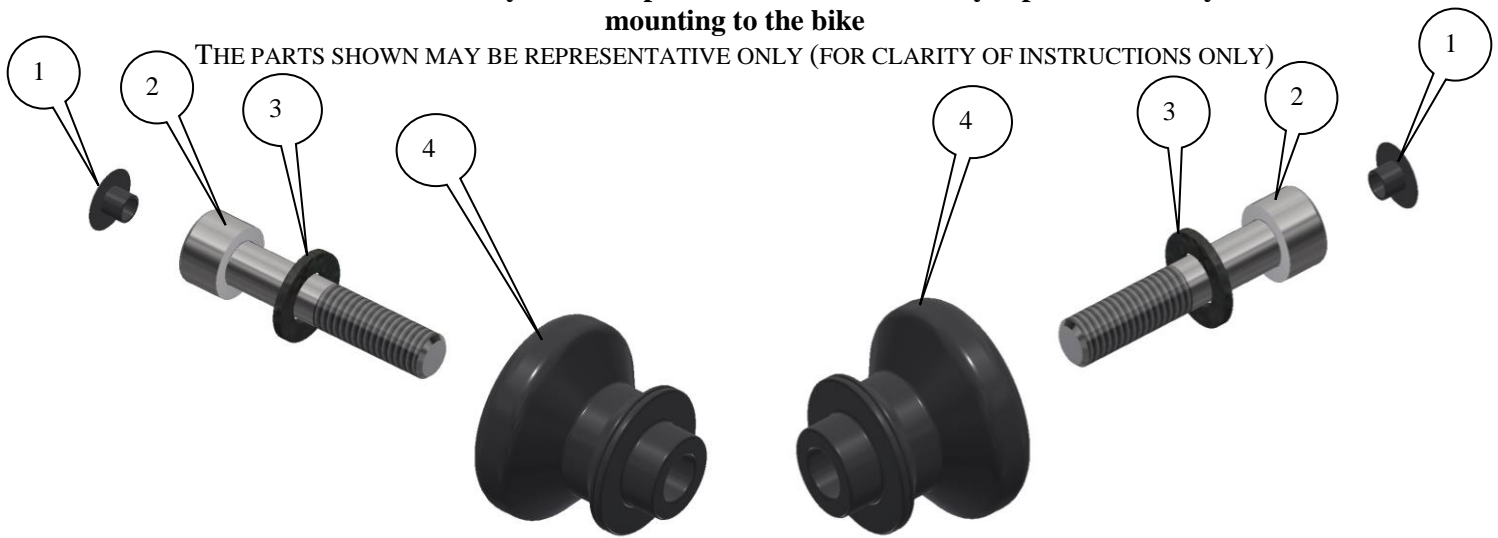

LEFT HAND SIDE

RIGHT HAND SIDE

LEGEND

- ITEM 1 = M8 Flat cap (NC0009) (x2).
- ITEM 2 = M8 x 40mm LONG CAP HEAD BOLTS (x2).
- ITEM 3 = M8 WASHERS (x2).
- ITEM 4 = COTTON REEL BOBBIN (B0444 with CS520) (x2).

Please note that in cases where kits are packed with rubber washers holding the components onto the bolt – *the rubber washers should be thrown away!*

R&G Racing
Unit 1, Shelley's Lane, East Worldham, Alton, Hampshire, GU34 3AQ
Tel: +44 (0)1420 89007 Fax: +44 (0)1420 87301 www.rg-racing.com Email: info@rg-racing.com



CR0068

TOOLS REQUIRED

- Set of Metric Allen keys to include 6mm A/F.

Page | 2

FITTING INSTRUCTIONS

Please read all instructions before commencing fitting

- Fit one of the M8 socket head bolts through either washer and then through either of the crash protector bobbins/paddock stand bobbins as shown above.
- Tighten into the threaded boss on the swing-arm as shown in the top pictures.
- Repeat the above process for the other side of the swing-arm.
- Push the flat caps into the bolt heads on both sides.

Please ensure no parts of the cotton reels or paddock stand can contact any parts of the motorcycle when in operation

Digital copies of these instructions are available to download from www.rg-racing.com

GENERAL TORQUE SETTINGS

M4 BOLT = 8Nm
M5 BOLT = 12Nm
M6 BOLT = 15Nm
M8 BOLT = 20Nm
M10 BOLT = 40Nm

ISSUE 1 17/04/2018 (NSY)

CONSUMER NOTICE

The catalogue description and any exhibition of samples are only broad indications of the Products and R&G may make design changes which do not diminish their performance or visual appeal and supplying them in such state shall conform to the order. The Buyer acknowledges no representation or warranty (other than as to title) has been given or will apply to the Products other than those in R&G's order or confirmation and the Buyer confirms it has chosen the Products as being of merchantable quality and suitable for its particular purposes. Where R&G fits the Products or undertakes other services it shall exercise reasonable skill and care and rectify any fault free of charge unless the workmanship has been disturbed. The Buyer is responsible for ensuring that the warranty on the motorcycle is not affected by the fitting of the Products. On return of any defective Products R&G shall at its option either supply a replacement or refund the purchase money but shall not be liable if the Products have been modified or used or maintained otherwise than in accordance with R&G's or manufacturer's instructions and good engineering practice or if the defect arises from accident or neglect. Other than identified above and subject to R&G not limiting its liability for causing death and personal injury, it shall not be liable for indirect or consequential loss and otherwise its liability shall be limited to the amounts paid by the Buyer for the Products or the fitting or service concerned. These terms do not affect the Buyer's statutory rights.

R&G RACING RETURNS POLICY (NON-FAULTY GOODS)

Returns must be pre-authorized (if not pre-authorized the return will be rejected). Goods may only be returned direct to us if they were purchased direct from us (customer must prove if necessary). Otherwise to be returned to original vendor. Goods must be in re-sellable condition, in the opinion of R&G Racing. All returns are subject to a 25% restocking and handling fee (25% of the gross value exc. P&P – at the prevailing price at time of purchase). The customer must pay any and all carriage charges. No returns of discontinued products, unless within 14 days of purchase. This policy does not affect your statutory rights and does not refer to faulty goods.

R&G Racing

Unit 1, Shelley's Lane, East Worldham, Alton, Hampshire, GU34 3AQ

Tel: +44 (0)1420 89007 Fax: +44 (0)1420 87301 www.rg-racing.com Email: info@rg-racing.com



CR0068

NOTICE DE MONTAGE POUR CR0068BK/WH BOBINES
KAWASAKI NINJA 400 2018-

Page | 3



LE KIT CONTIENT LES ARTICLES EXPOSES CI-DESSOUS, VERIFIER QUE TOUTES LES PIECES SOIENT PRESENTES AVANT DE PROCEDER AU MONTAGE.

LA FACON DONT LE KIT EST EMBALLE NE CORRESPOND PAS FORCEMENT A LA FACON DE MONTER LES PIECES SUR LA MOTO.

LES PARTIES PRESENTEES PEUVENT ETRE UNIQUEMENT REPRESENTATIVES (POUR LA CLARTE DES INSTRUCTIONS UNIQUEMENT

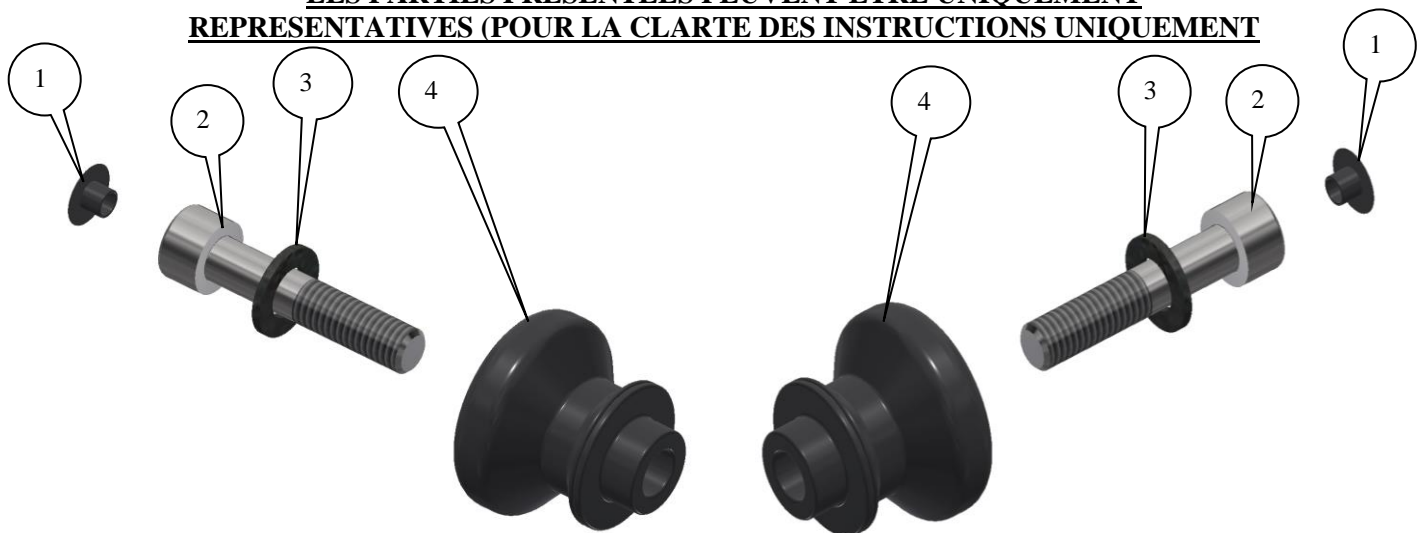

COTE GAUCHE

COTE DROIT

LEGENDE

- ARTICLE 1 = M8 Flat cap (NC0009) (x2).
- ARTICLE 2 = M8 x 45mm BOULONS (x2).
- ARTICLE 3 = M8 RONDELLES (x2).
- ARTICLE 4 = BOBINES (B0444 avec CS520) (x2).

R&G Racing

Unit 1, Shelley's Lane, East Worldham, Alton, Hampshire, GU34 3AQ

Tel: +44 (0)1420 89007 Fax: +44 (0)1420 87301 www.rg-racing.com Email: info@rg-racing.com



CR0068

Notez que si les kits sont emballés avec des rondelles en caoutchouc servant à tenir les composants, *ces rondelles doivent être jetées !*

Page | 4

OUTILS REQUIS

- Jeu de clés Allen comprenant une clé de 6mm.

NOTICE DE MONTAGE :

Lire la notice avant de procéder au montage

- Insérer un des boulons M8 dans l'une des rondelles puis dans les protections crash/bobines de protection de béquille de stand, voir ci-dessus.
- Serrer dans le trou fileté du bras oscillant, voir les photos ci-dessus.
- Répéter le process ci-dessus de l'autre coté du bras oscillant.
- **Push the flat caps into the bolt heads on both sides.**

Veiller à ce qu'aucune partie des bobines ou de béquille ne puisse entrer en contact avec quelque partie de la moto lors de son utilisation.

Notice disponible au téléchargement sur www.rg-racing.com

COUPLES DE SERRAGE RECOMMANDES

M4 BOULON = 8Nm
M5 BOULON = 12Nm
M6 BOULON = 15Nm
M8 BOULON = 20Nm
M10 BOULON = 40Nm

**ISSUE 1 17/04/2018 (NSY)
CONSUMER NOTICE**

The catalogue description and any exhibition of samples are only broad indications of the Products and R&G may make design changes which do not diminish their performance or visual appeal and supplying them in such state shall conform to the order. The Buyer acknowledges no representation or warranty (other than as to title) has been given or will apply to the Products other than those in R&G's order or confirmation and the Buyer confirms it has chosen the Products as being of merchantable quality and suitable for its particular purposes. Where R&G fits the Products or undertakes other services it shall exercise reasonable skill and care and rectify any fault free of charge unless the workmanship has been disturbed. The Buyer is responsible for ensuring that the warranty on the motorcycle is not affected by the fitting of the Products. On return of any defective Products R&G shall at its option either supply a replacement or refund the purchase money but shall not be liable if the Products have been modified or used or maintained otherwise than in accordance with R&G's or manufacturer's instructions and good engineering practice or if the defect arises from accident or neglect. Other than identified above and subject to R&G not limiting its liability for causing death and personal injury, it shall not be liable for indirect or consequential loss and otherwise its liability shall be limited to the amounts paid by the Buyer for the Products or the fitting or service concerned. These terms do not affect the Buyer's statutory rights.

R&G RACING RETURNS POLICY (NON-FAULTY GOODS)

Returns must be pre-authorized (if not pre-authorized the return will be rejected). Goods may only be returned direct to us if they were purchased direct from us (customer must prove if necessary). Otherwise to be returned to original vendor. Goods must be in re-sellable condition, in the opinion of R&G Racing. All returns are subject to a 25% restocking and handling fee (25% of the gross value exc. P&P – at the prevailing price at time of purchase). The customer must pay any and all carriage charges. No returns of discontinued products, unless within 14 days of purchase. This policy does not affect your statutory rights and does not refer to faulty goods.

R&G Racing

Unit 1, Shelley's Lane, East Worldham, Alton, Hampshire, GU34 3AQ

Tel: +44 (0)1420 89007 Fax: +44 (0)1420 87301 www.rg-racing.com Email: info@rg-racing.com



CR0068

**MONTAGEANLEITUNG FÜR CR0068BK/WH VERSTETZE
MONTAGESTÄNDERAUFNAHMEN KAWASAKI NINJA 400 2018-**

Page | 5



**ALLE TEILE SIND UNTEN ABGEBILDET UND GEKENNZEICHNET. BEVOR SIE
MIT DER MONTAGE BEGINNEN, ÜBERPRÜFEN SIE, DASS ALLE TEILE
VORHANDEN SIND.**

Hinweis: Die Verpackung der Teile stellt nicht die Reihenfolge der Montage dar.

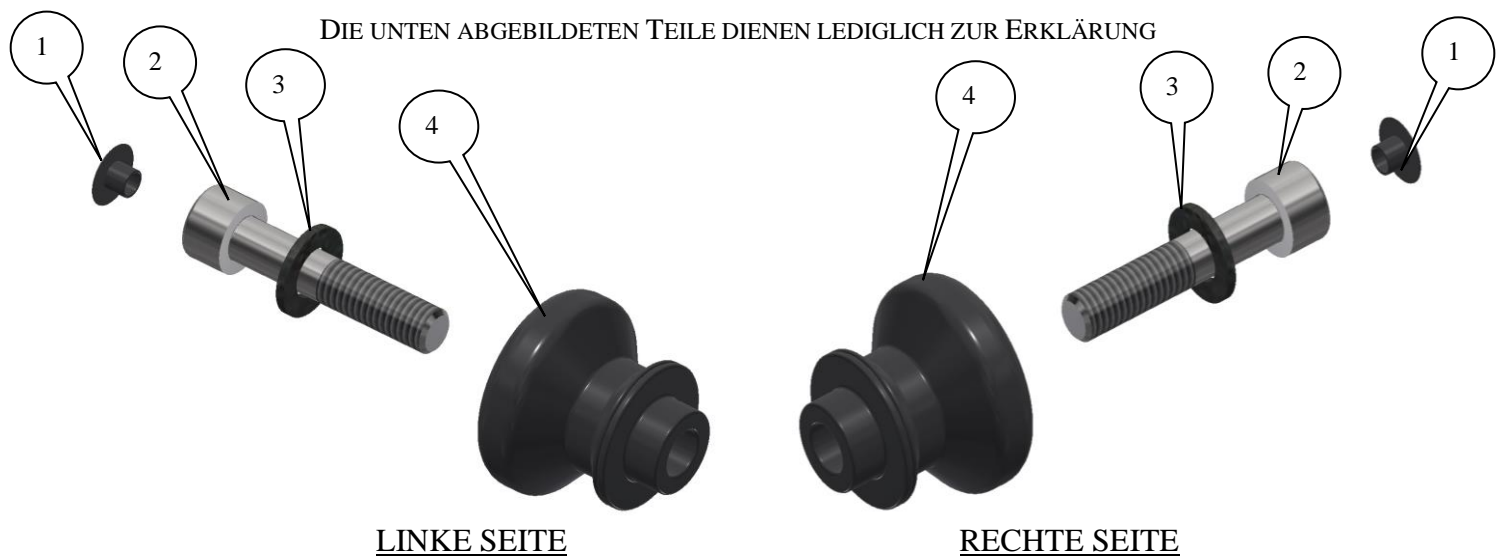

LIEFERUMFANG

- ARTIKEL 1 = M8 FLACHE KAPPE (NC0009) (x2)
- ARTIKEL 2 = M8 x 40mm INBUSSCHRAUBEN (x2)
- ARTIKEL 3 = M8 UNTERLEGSCHLEIBEN (x2)
- ARTIKEL 4 = MONTAGESTÄNDERAUFNAHMEN (BOBBIN) (B0444 mit CS520) (x2)

R&G Racing
Unit 1, Shelley's Lane, East Worldham, Alton, Hampshire, GU34 3AQ
Tel: +44 (0)1420 89007 Fax: +44 (0)1420 87301 www.rg-racing.com Email: info@rg-racing.com



CR0068

Hinweis für Kits mit Plastikunterlegscheiben an den Schrauben – *Diese Plastikunterlegscheiben werden nicht für den Einbau benötigt!*

Page | 6

SIE BENÖTIGEN FOLGENDES WERKZEUG

- Satz Inbusschlüssel mit 6mm A/F Inbusschlüssel

MONTAGEANLEITUNG

Bitte die Montageanleitung komplett durchlesen, bevor Sie mit der Montage beginnen.

- Eine M8 Schraube durch eine der beiden Unterlegscheiben führen dann in einen der Sturzpad-Bobbins / Rennsport-Montageständer Bobbins einführen wie oben abgebildet.
- Im Gewindeinsatz an der Schwinge wie oben in den Abbildungen abgebildet befestigen.
- Wiederholen Sie den oben beschriebenen Vorgang an der anderen Seite der Schwinge.
- An beiden Seiten die flachen Kappen an den Schraubenköpfen anbringen.

Bitte stellen Sie sicher, dass keine Teile der Montageständeraufnahmen / des Rennsport-Montageständers mit anderen Teilen des Motorrads in Berührung kommen. Fahren Sie nicht mit dem Motorrad bis dies sorgfältig überprüft wurde.

Eine digitale Version dieser Montageanleitung kann auf folgender Seite heruntergeladen werden:
www.rg-racing.com

ANZUGSDREHMOMENTE:

M4 SCHRAUBE = 8 Nm
M5 SCHRAUBE = 12 Nm
M6 SCHRAUBE = 15 Nm
M8 SCHRAUBE = 20 Nm
M10 SCHRAUBE = 40 Nm

AUSGABE 1 17/04/2018 (NSY)

CONSUMER NOTICE

The catalogue description and any exhibition of samples are only broad indications of the Products and R&G may make design changes which do not diminish their performance or visual appeal and supplying them in such state shall conform to the order. The Buyer acknowledges no representation or warranty (other than as to title) has been given or will apply to the Products other than those in R&G's order or confirmation and the Buyer confirms it has chosen the Products as being of merchantable quality and suitable for its particular purposes. Where R&G fits the Products or undertakes other services it shall exercise reasonable skill and care and rectify any fault free of charge unless the workmanship has been disturbed. The Buyer is responsible for ensuring that the warranty on the motorcycle is not affected by the fitting of the Products. On return of any defective Products R&G shall at its option either supply a replacement or refund the purchase money but shall not be liable if the Products have been modified or used or maintained otherwise than in accordance with R&G's or manufacturer's instructions and good engineering practice or if the defect arises from accident or neglect. Other than identified above and subject to R&G not limiting its liability for causing death and personal injury, it shall not be liable for indirect or consequential loss and otherwise its liability shall be limited to the amounts paid by the Buyer for the Products or the fitting or service concerned. These terms do not affect the Buyer's statutory rights.

R&G RACING RETURNS POLICY (NON-FAULTY GOODS)

Returns must be pre-authorized (if not pre-authorized the return will be rejected). Goods may only be returned direct to us if they were purchased direct from us (customer must prove if necessary). Otherwise to be returned to original vendor. Goods must be in re-sellable condition, in the opinion of R&G Racing. All returns are subject to a 25% restocking and handling fee (25% of the gross value exc. P&P – at the prevailing price at time of purchase). The customer must pay any and all carriage charges. No returns of discontinued products, unless within 14 days of purchase. This policy does not affect your statutory rights and does not refer to faulty goods.

R&G Racing

Unit 1, Shelley's Lane, East Worldham, Alton, Hampshire, GU34 3AQ

Tel: +44 (0)1420 89007 Fax: +44 (0)1420 87301 www.rg-racing.com Email: info@rg-racing.com